

LEGEND

INITIAL

CABINET CONSTRUCTION:	EGGER WHITE W954 #92240 (5'x9')
COUNTERTOP:	STONE BY OTHERS
DRAWER CONSTRUCTION:	EGGER WHITE W954 #92240 (5'x9')
DRAWER SLIDES:	UNDERMOUNT SOFT CLOSING SLIDES
EXTERIOR FINISH 1:	LIOHER WHITE GLOSS PANELS
EXTERIOR FINISH 2:	N/A
INTERIOR FINISH:	EGGER WHITE W954 #92240 (5'x9')
DOOR STYLE:	SLAB
HANDLES:	PROVIDED BY OTHERS, INSTALLED BY MMW
HINGES:	SOFT CLOSING CONCEALED HINGES
LIGHTS:	NONE
MOULDING:	N/A
APPLIANCES:	LG WASHTOWER 4.5 cu. ft. WASHER AND 7.4 cu. ft. DRYER WKEX200HWA
FIELD DIMENSIONS:	APPLIED
MISCELLANEOUS:	AVENTOS HK LIFT MECHANISM 22K2700T

MADISON MILLWORK & CABINET CO., INC.

EMAIL: glenn@madisonmillwork.net

PHONE: (954) 966-7551

FAX: (954) 966-0805

PROJECT NAME: GLIKIN LAUNDRY

CLIENT: WHITEHAVEN CONSTRUCTION

PHONE #

EMAIL:

DELIVERY DATE:

INSTALLATION TIME FRAME:

DRAWING DATES:

INITIAL	06-22-23
R1	06-22-23

PROJECT ADDRESS:

DRWG#AS062223-1400

(02162C-07) GLIKIN - LAUNDRY (1175)

SIGNATURE OF APPROVAL:

DATE OF APPROVAL:

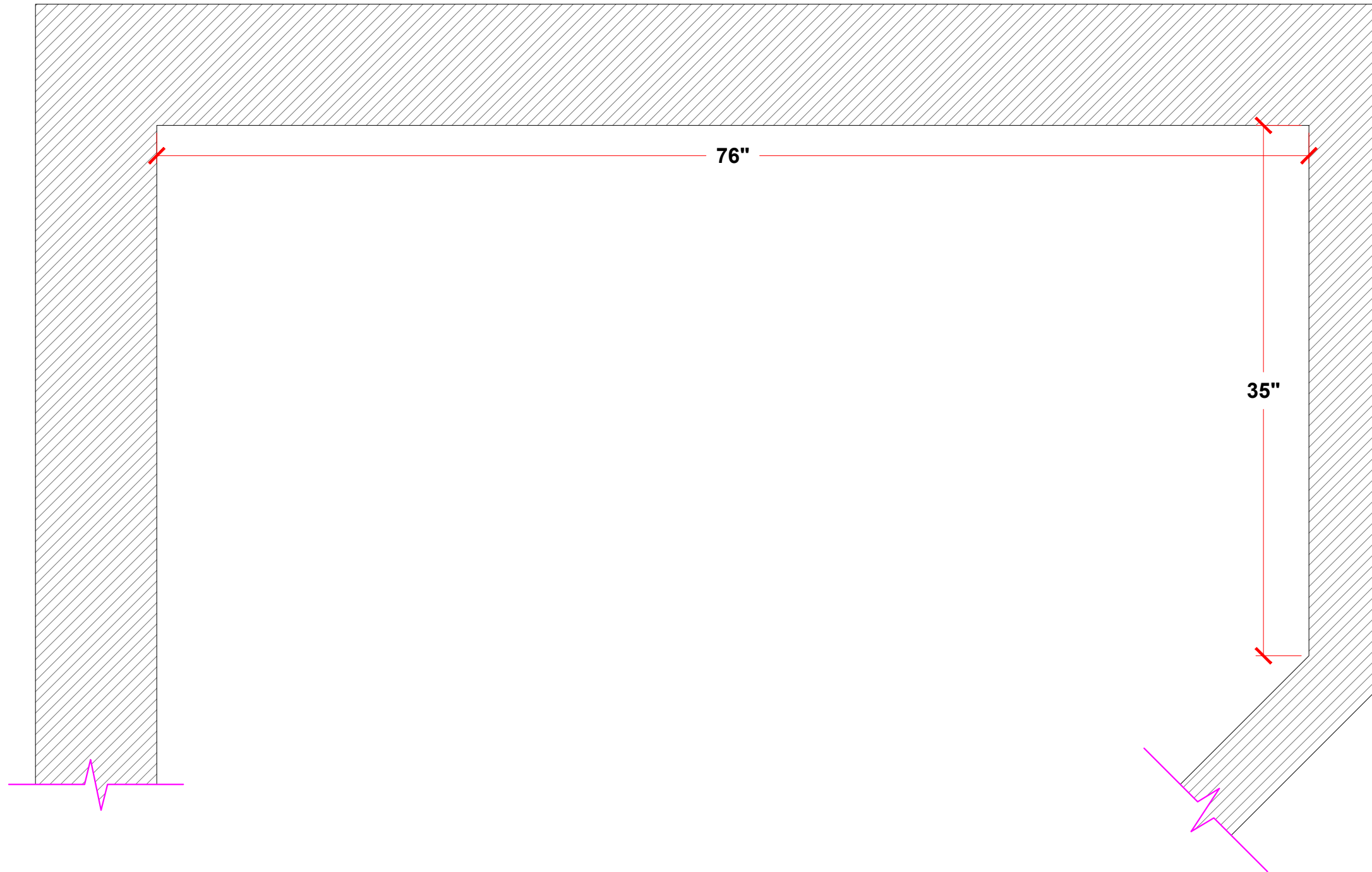

PLAN VIEW - WALL DIMENSIONS
GLIKIN - LAUNDRY (02162C-07)

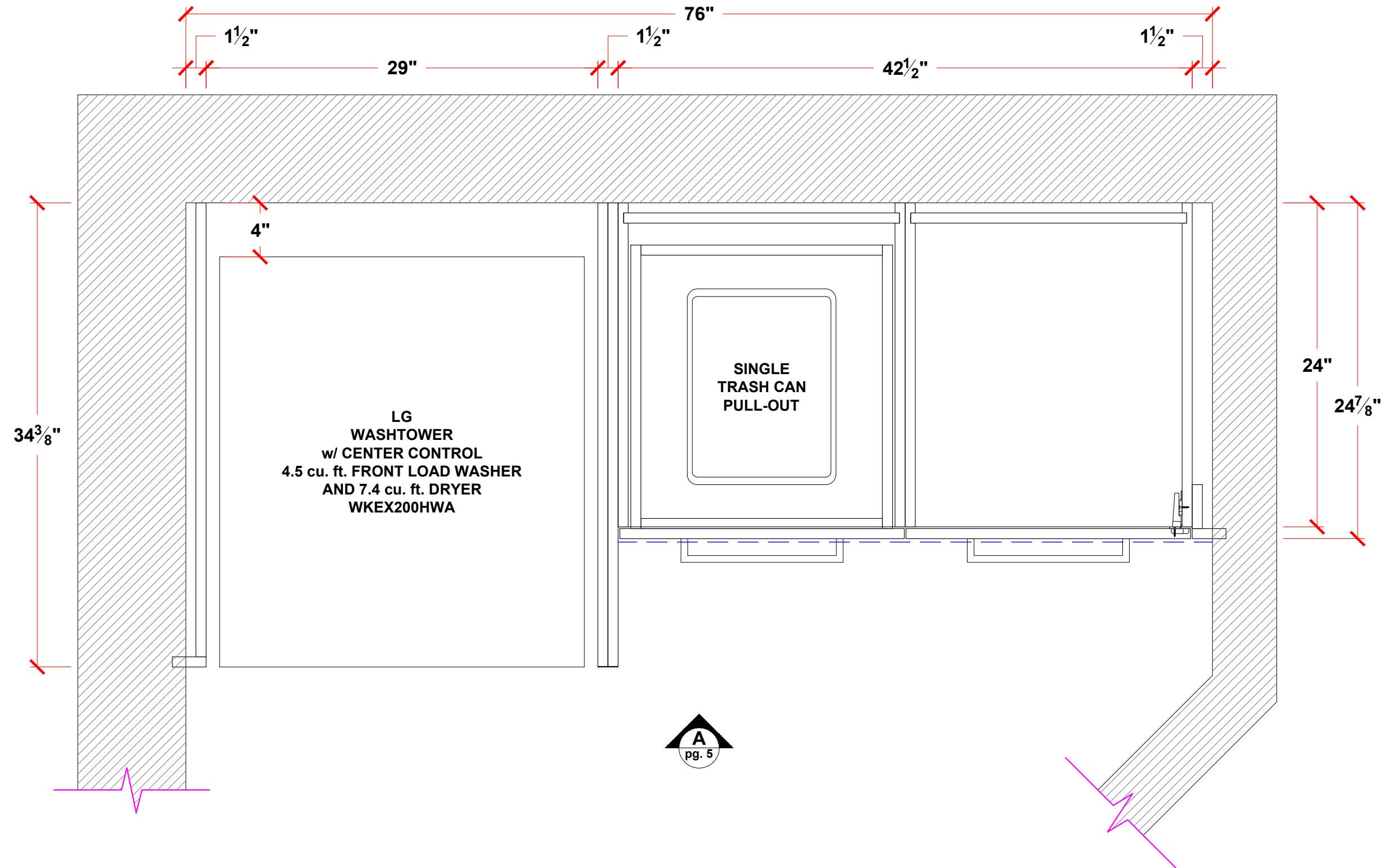

PLAN VIEW - BASE CABINETS
GLIKIN - LAUNDRY (02162C-07)

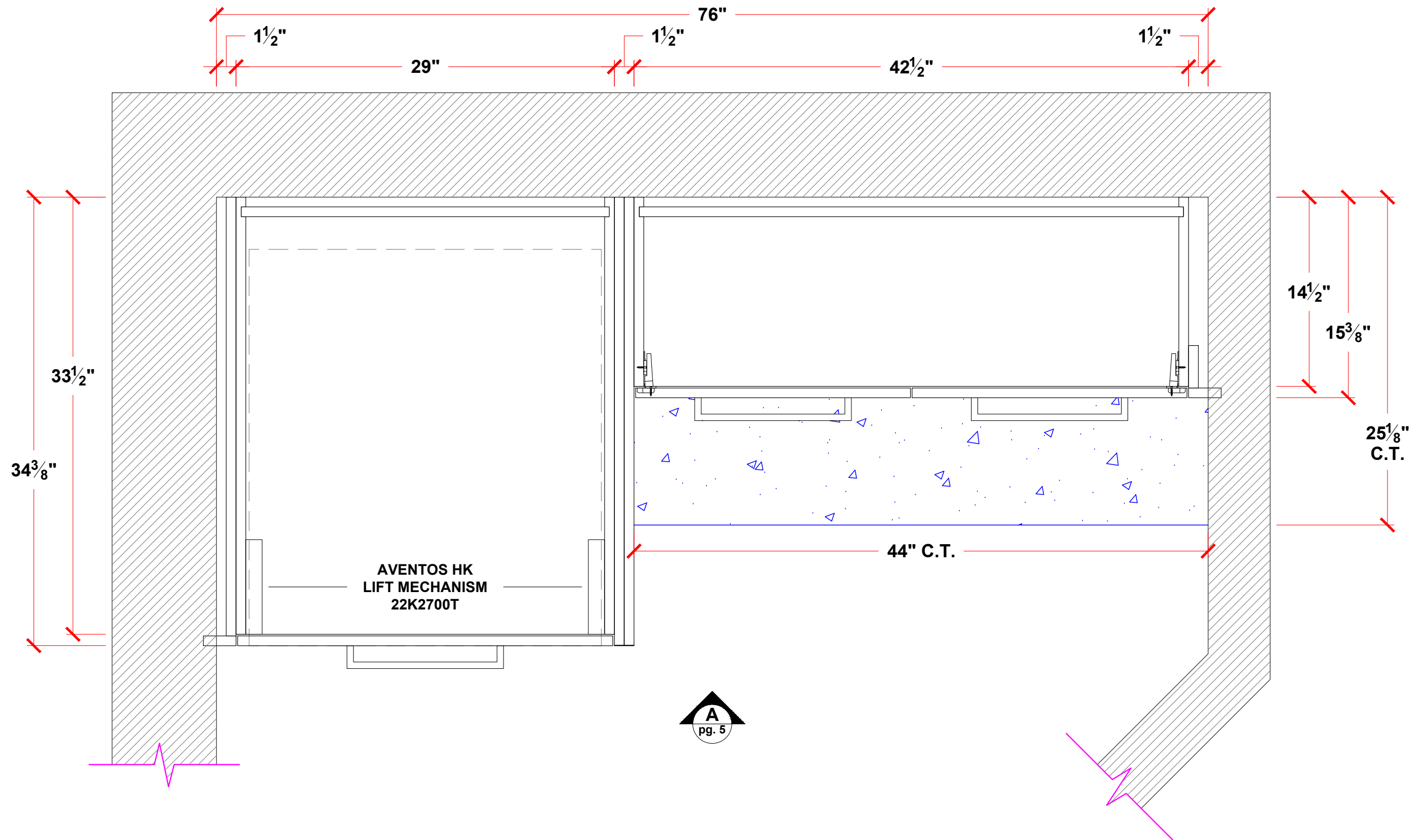

PLAN VIEW - UPPER CABINETS
GLIKIN - LAUNDRY (02162C-07)

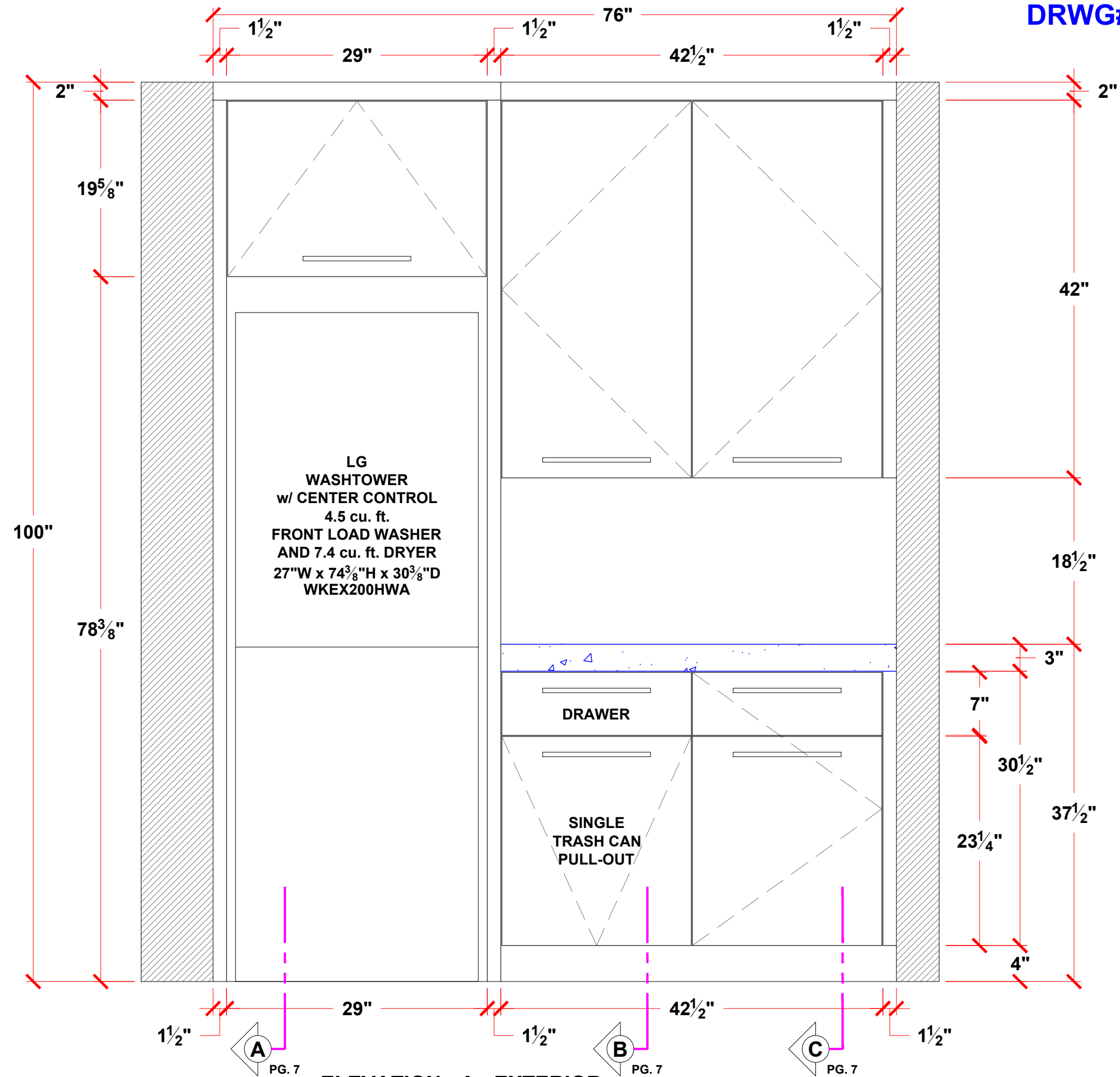

LG
WASHTOWER
w/ CENTER CONTROL
4.5 cu. ft.
FRONT LOAD WASHER
AND 7.4 cu. ft. DRYER
27"W x 74³/₈"H x 30³/₈"D
WKEX200HWA

DRAWER

SINGLE
TRASH CAN
PULL-OUT

A
PG. 7

B
PG. 7

C
PG. 7

ELEVATION - A - EXTERIOR
GLIKIN - LAUNDRY (02162C-07)

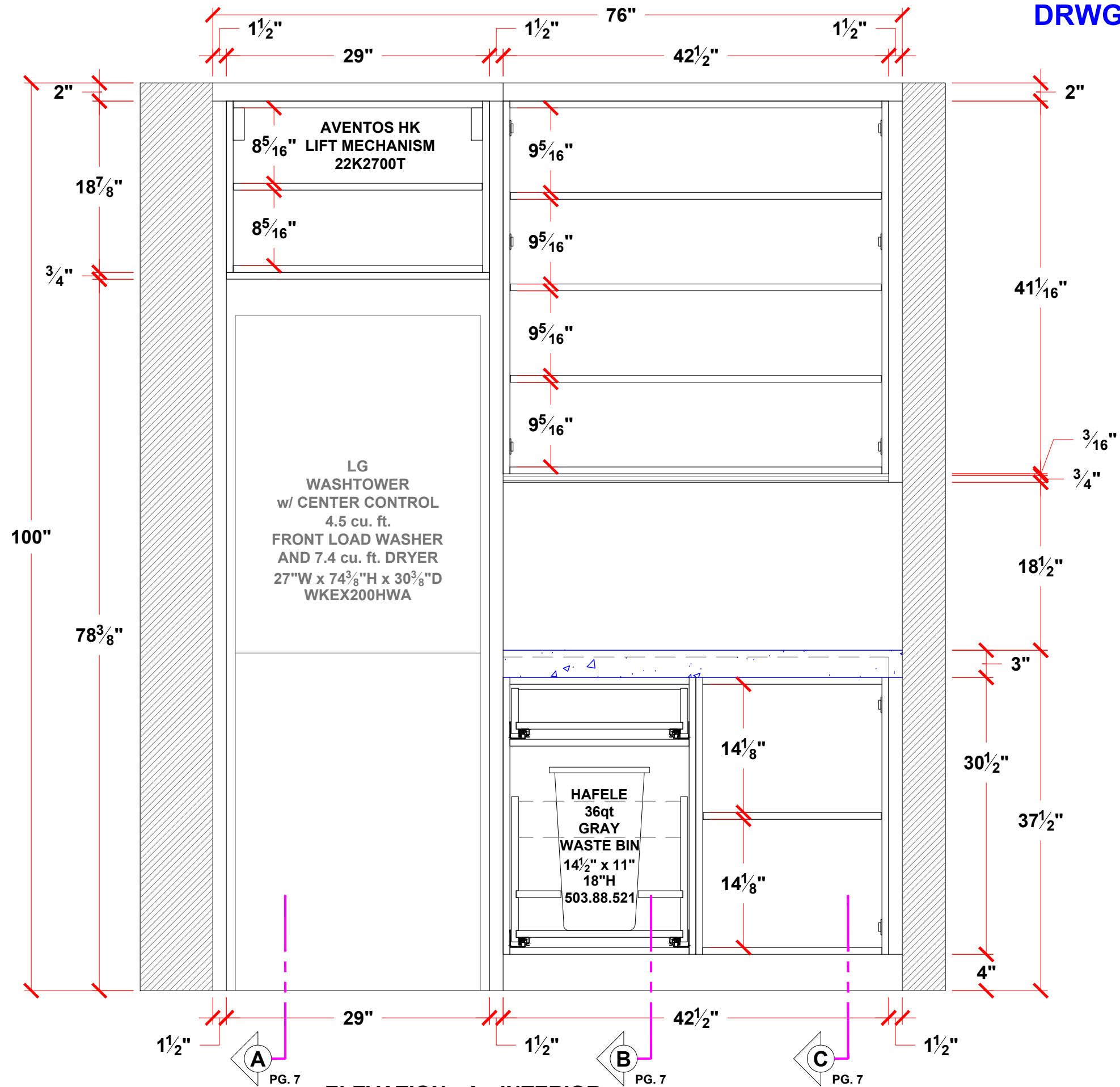

ELEVATION - A - INTERIOR
GLIKIN - LAUNDRY (02162C-07)

